

WAM05112020

**AIRMATIC**®  
**WE'LL HANDLE IT.**



# PINCH VALVES

## VM Series

**AIRMATIC**  
284 Three Tun Rd. Malvern, PA 19355  
215.333.5600  
infocenter@airmatic.com  
airmatic.com

## PINCH VALVES VM

High performance shut-off valve for pneumatic conveying systems for powders, granular or slurries; improves process efficiency thanks to quick and easy maintenance, no turbulences and pressure losses thanks to full bore sleeves integrating the valve to the pipeline.

By introducing compressed air through the threaded bore into the interior of the valve, the internal flexible sleeve is reshaped in such a way as the passage is hermetically sealed.

VM Pinch Valves equally handle pneumatically conveyed powders, granules, fibres, dense mixtures or liquids.

### AVAILABLE PASSAGE DIAMETERS:

1/2", 3/4", 1", 1-1/4", 1-1/2", 2", 2-1/2", 3", 4", 5", 6", 8"

### FEATURES

- Working Temperature: from 15°F up to 175°F
- Pi Internal Max. Pneumatic Conveying System Pressure: 60 PSI
- Pc Closure control pressure: Pi + 40 PSI (max. 90 PSI)

### CONTROL PANEL VMX

Designed for operating the VM Pinch Valves, enabling:

- Open / Close air supply to the "VM" by the solenoid valve
- Adjust the closing pressure to "VM"
- 9 Get information on the pressure line to "VM" by means of a 2.5 bar preset pressure



#### CONTROL PANEL VMX01N



Standard version

#### CONTROL PANEL VMX01NX



ATEX certified Ex II 3D T 275°F  
Ambient Temperature : 23°F / + 105°F

### BENEFITS

- Compact overall dimensions;
- Easy and quick sleeve and bush replacement;
- Full bore-through passage without any pressure loss;
- No product contact with the casing;
- Sleeves manufactured from fabric-reinforced material;
- Sleeve support bushes either made from aluminum alloy, hardened carbon steel or 304 stainless steel;
- Apart from periodic replacement of the sleeve and the bushes, no maintenance required; Lightweight in comparison with other makes and other types of valve;
- Particularly low air consumption;
- Food-grade contact parts.

**1 Casing**

Cast aluminium alloy

**2 Sleeve**

 NR Natural Rubber  
 anti-abrasion

 NBR Natural Rubber  
 food-grade

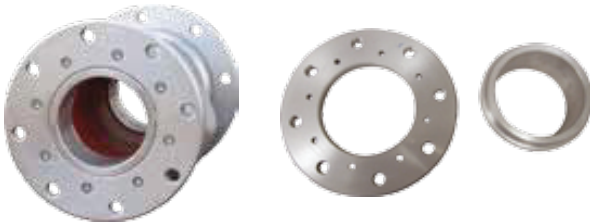
**3 Connection Processes**
**FLANGES AND BUSHES - Passage diameter from 1.75" up to 7.87"**

**FLANGE: - Aluminum alloy**  
**BUSHES: - Aluminum alloy**

- Hardened Steel
- 304 Stainless Steel

**THREADED BUSHES - Passage diameter from 0.5" up to 3.9"**

**Diameter from 0.5" up to 3.9"**

- Polymer
- Diameter from 1.6" to 3.9"**
- Aluminum alloy
- Nickel Coated
- 304 Stainless Steel

**4 Gaskets (Flanged only)**

Black

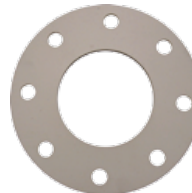
 Food-grade  
 white

**VM Pinch Valves** are used for material flow interception in pneumatic conveying systems, or other pipelines. They can be installed as a locking device for silo filling pipes.

In the open position the internal cross section of the valve is identical with the connecting pipe diameter.





**AIRMATIC** founded in 1944, is a woman-owned Industrial Distributor, with installation and maintenance capabilities, offering equipment, machinery, and shop supplies to the Industrial, Construction, Utility, Government, and Commercial Markets. Our products and services are sold through three business units:

The **MATERIALS MANAGEMENT GROUP** provides products and services to industries that convey, store, transport, and process powders and bulk solids from aggregates, cement, and chemicals to foods, grains, metals, power generation, and waste water treatment applications;

The **SERVICE GROUP** provides fabrication, installation, and maintenance services to improve bulk materials handling efficiency; mechanical clean-out services for silos and hoppers to eliminate material flow problems; and shop repair/rebuilding and modifications services of products sold by the Company.

The **TOOL GROUP** provides power tools, personal protective equipment, materials-handling equipment, shop equipment and MRO supplies used for production, fabrication, assembly, metal removal, maintenance, and storage in manufacturing, construction, utility, and commercial applications.

**Our Customers tell us that by choosing AIRMATIC to solve their problems, they gain increased productivity, decreased costs, and a safer, cleaner work environment.**



**WAM** is a worldwide leader in developing and manufacturing equipment and plant components for bulk solids handling and processing, has been represented in the United States by its own subsidiary since 1985. WAM Inc. is responsible for distribution of the WAMGROUP product range in the U.S. and Canada.

## **AIRMATIC**

284 Three Tun Rd. Malvern, PA 19355

215.333.5600

infocenter@airmatic.com

airmatic.com